

TACMOLLE

PRODUCT INSTALLATION MANUAL

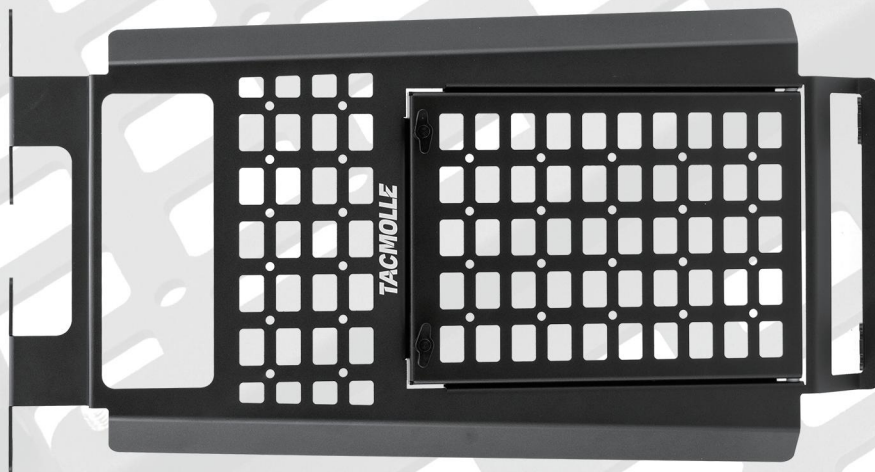

20393

PACKAGE INCLUDED



INSTALLATION INSTRUCTIONS



1. Prepare the Roof MOLLE Panel and tools.



2. Remove the roof's front panel.



3. Move both sun visors to the side.



4. Gently remove the upper protective panel.



5. As shown, loosen the screws on both sides, do not remove them completely.

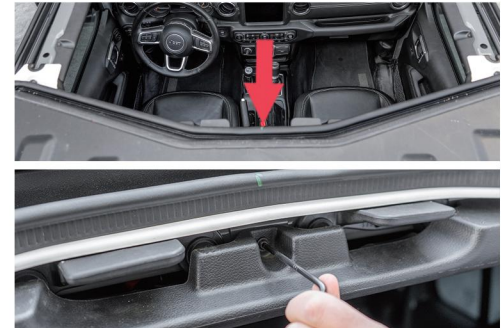

6. Remove the screws at the rear.

INSTALLATION INSTRUCTIONS

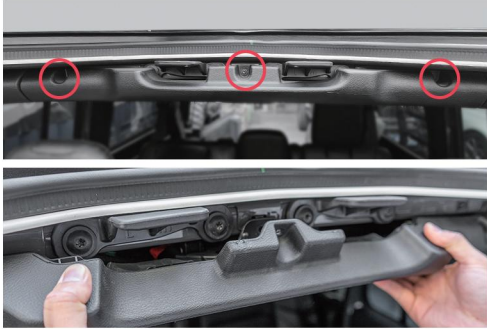

7. Remove the three screws in the middle and on both sides, then set them aside. Gently push the rear top panel down.



8. Remove and set aside the interior parts on both sides.



9. Prepare to install the Roof MOLLE Panel according to the provided direction.



10. Align the holes on the Roof MOLLE Panel with those on the roof.



11. Reinstall the interior parts, ensuring correct left and right placement.



12. Reattach the parts with the original screws, but do not tighten them completely.

INSTALLATION INSTRUCTIONS



13. The connection effect of the rear part of the Roof MOLLE Panel.



14. Prepare to install the front part.



15. Align all installation holes as shown.



16. Once aligned, tighten the screws on both sides.



17. Tighten the screws at the rear.



18. Close the rear top panel.

INSTALLATION INSTRUCTIONS



19. As shown, reinstall the three screws removed earlier and tighten them.



20. Close the front top panel.

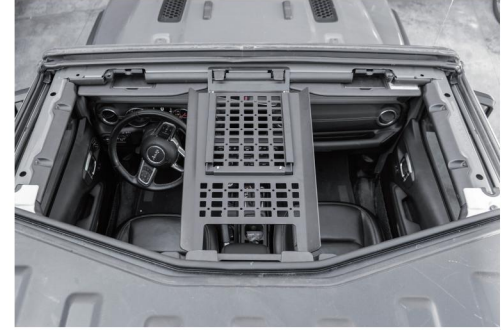

21. Check the installation result.



22. Reinstall the roof's front panel.

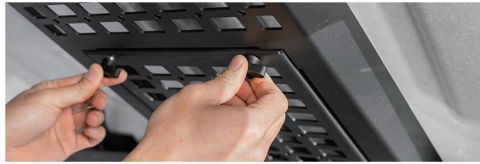

23. Loosen the Roof MOLLE Panel screws, open the panel, then secure the front roof panel.



24. Installation inside is complete.

PRODUCT DEMONSTRATION



TACMOLLE